



20/50 Suttor Drive Success WA

3 2 2

Must Sale !!!

Perfectly positioned for convenience and comfort, this modern 3-bedroom, 2-bathroom survey strata home is an ideal choice for those seeking a secure, easy-care lifestyle or a smart investment. Located in a quiet street, it offers peace of mind and minimal upkeep, allowing you to spend more time enjoying the things you love.

Inside, you'll find three generous bedrooms, each with built-in wardrobes. Two bedrooms feature brand-new carpets for a fresh, cozy feel, while the rest of the home benefits from low-maintenance tiled flooring. Split system air-conditioners in the bedrooms ensure year-round comfort, and the stylish downlights create a warm and inviting atmosphere.

[For full version visit the website](https://www.agency168.com.au)

Type : House
Building Size : 143 sqm
Land Size : 268 sqm
View : <https://www.agency168.com.au/8449402>



Shirley Lo-Leeson
0433512875



20/50 Suttor Drive, Success

This floor plan is not to scale.
 Dimensions are approximate and therefore should only be used for illustrative purposes.

-  163 m²
-  3 Bed
-  2 Bath
-  2 Car

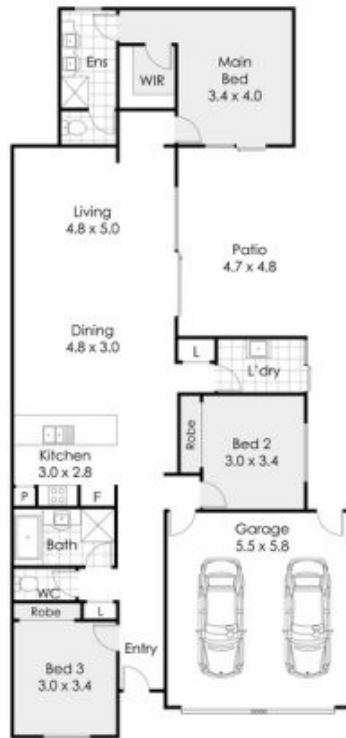

20/50 Suttor Drive, Success

This floor plan is not to scale.
 Dimensions are approximate and therefore should only be used for illustrative purposes.

	163 m ²
	3 Bed
	2 Bath
	2 Car